

General information

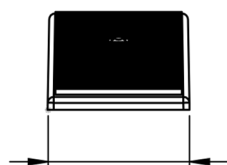

23,5 mm

Overview

Professional Levelit wedges allow you to align all tiles while ensuring a perfect joint width between the tiles. The wedges are made from hard-wearing plastic so they can be used again and again. Levelit wedges are used in combination with spacers and leveling pliers.

Recycling instructions

The product is not hazardous or toxic and it is suitable for recycling. If it can't be recycled, the waste material can be disposed at a suitable landfill site, or at an approved waste incineration facility in accordance with applicable local, provincial, state and federal regulations.

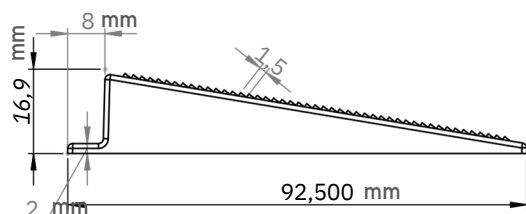

Storage information

The product should be stored in a dry area with an ambient temperature below 50°C. It should be kept away from sunlight, sparks, heat and flame. Inappropriate storage conditions can lead to color changes and the deterioration in physical properties.

Classification of the Substance

Substance is currently not listed in ANNEX VI of EU CLP Regulation No 1272/2008.

Raw Materials



Type of material

Polystyrene (PS)

Material Code

GPPS 525

Colour

Natural + Masterbatch

Product specifications

Specifications	Unit	Specification	Test Methods
Melt Flow Index	g/10 min.	8 – 12	ASTM D 1238
Notched Izod Impact @ 23°C	J/m	min. 11,76	ASTM D 256
Vicat Softening Point@10N	°C	min. 95	ASTM D 1525
Heat Distortion @ 0.45 Mpa	°C	min. 90	ASTM D 648
Tensile Properties			ASTM D 638
Strength at break	MPa	min. 3726	
Elongation at break	%	min. 1,5	
Tensile Modulus	MPa	2941 – 3432	
Flexural Properties			
Flexural Strength	MPa	min. 6864	
Flexural Modulus	MPa	2745 – 3530	